

## DCH-S161 Wi-Fi Water Sensor



### Product Highlights

**Water Detection Alerts**

A push notification when water is detected<sup>1</sup>

**Battery Powered**

Lasts up to 1.5 years on 2 AA batteries<sup>2</sup>

**Smart Home Compatible**

Works with mydlink Smart Home Devices, the Google Assistant and IFTTT<sup>3</sup>

### Protect Your Home

The DCH-S161 Wi-Fi Water Sensor is a wireless sensor that helps keep your home safe. You can install the probe anywhere and it will help you detect water leaks before it turns into serious damage. If the water sensor is triggered, a 90 dB alarm will sound and an LED will blink to give you audio and visual warnings. Push notifications to your mobile device let you keep tabs on your home on the go. You can also receive audio alerts from your Google Assistant so that you can know about a water leak even if you are too far away to hear the alarm on the water sensor.

### Easy to Set Up

The DCH-S161 can be set up easily via the free mydlink™ app<sup>4</sup>. Simply download and install the app on your mobile device and follow the step-by-step instructions to quickly configure the sensor. The DCH-S161 connects to your existing Wi-Fi router, no hub required. In addition, you can configure policies to trigger other connected home devices whenever the DCH-S161 detects water.

### Specially Designed Detection Cable

The water detection sensor supplied with the DCH-S161 is designed specifically to detect water on contact. When water is detected, the sensor will trigger both an alarm siren and an alarm LED so you can both hear and see the warning. The sensor is at the end of a 1.8 m (5.9 ft) cable, allowing you to place the sensor anywhere that's convenient.

### Access Anywhere Using the Mobile App

When water is detected the mydlink™ app sends push notifications to your mobile device no matter where you are. With push notifications, you can rest assured that you are always aware of any problems so you can act fast.

### Features

- ◆ Compatible with the Google Assistant and IFTTT
- ◆ Get audio alerts from your Google Assistant
- ◆ 90 decibel siren
- ◆ Wireless 802.11 n/g compatibility
- ◆ WPA/WPA2 wireless encryption
- ◆ mydlink™ app integration
- ◆ Firmware Over The Air (FOTA)
- ◆ Low battery notification
- ◆ 1.8 m (5.9 ft) cable for water detector

## Product Images

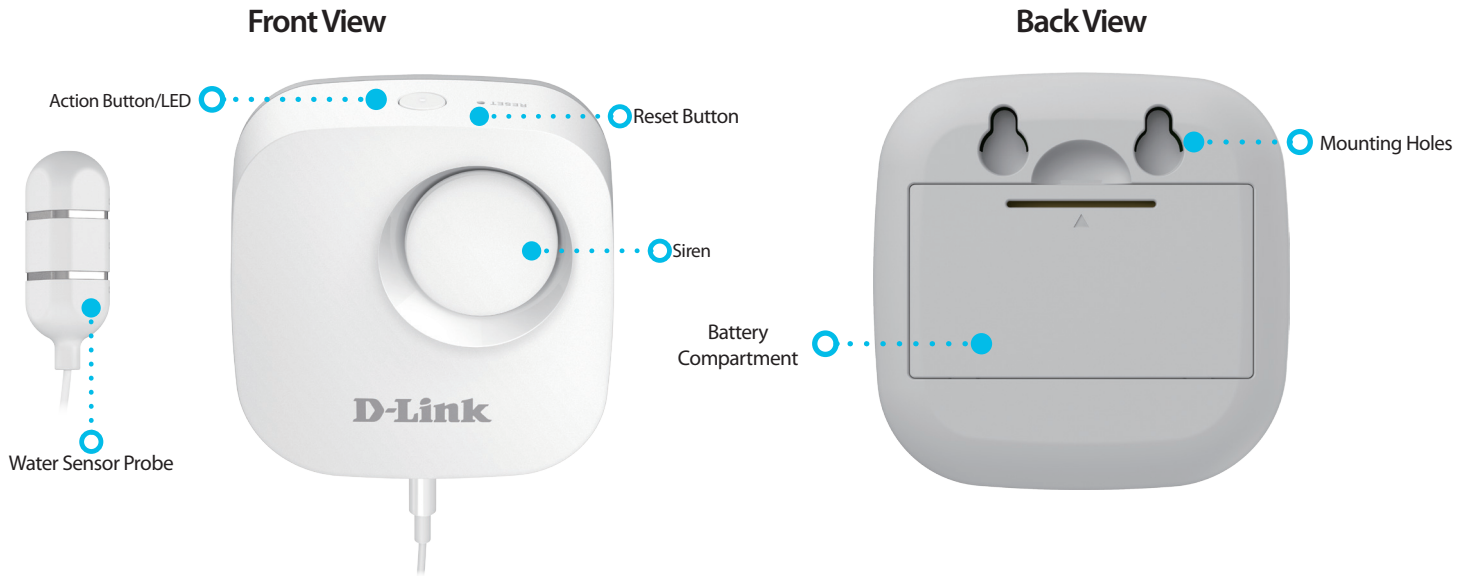

## Technical Specifications

General		
Device Interfaces	<ul style="list-style-type: none"> <li>• 802.11n/g wireless</li> <li>• Action button</li> </ul>	<ul style="list-style-type: none"> <li>• Reset button</li> </ul>
LED	<ul style="list-style-type: none"> <li>• Status</li> </ul>	
Standards	<ul style="list-style-type: none"> <li>• IEEE 802.11n</li> </ul>	<ul style="list-style-type: none"> <li>• IEEE 802.11g</li> </ul>
Wireless Frequency Range	<ul style="list-style-type: none"> <li>• 2.4 GHz to 2.4835 GHz</li> </ul>	
Water Sensor Probe	<ul style="list-style-type: none"> <li>• 1.8 m (5.9 ft)</li> </ul>	
Antennas	<ul style="list-style-type: none"> <li>• 1 x internal antenna</li> </ul>	
Alarm Volume	<ul style="list-style-type: none"> <li>• 90 dB</li> </ul>	
Functionality		
Wireless Encryption	<ul style="list-style-type: none"> <li>• Wi-Fi Protected Access (WPA/WPA2)</li> </ul>	
Supported Features	<ul style="list-style-type: none"> <li>• Google Assistant</li> <li>• IFTTT</li> </ul>	<ul style="list-style-type: none"> <li>• Push notifications</li> </ul>
Device Management	<ul style="list-style-type: none"> <li>• mydlink™ app</li> </ul>	
Physical		
Dimensions	<ul style="list-style-type: none"> <li>• 68 x 68 x 31 mm (2.68 x 2.68 x 1.22 in)</li> </ul>	
Weight	<ul style="list-style-type: none"> <li>• Device: 60 g ± 5 g (2.12 oz ± 0.18 oz)</li> </ul>	<ul style="list-style-type: none"> <li>• Probe: 17 g ± 5 g (0.60 oz ± 0.18 oz)</li> </ul>
Power	<ul style="list-style-type: none"> <li>• 2 x AA batteries</li> </ul>	
Temperature	<ul style="list-style-type: none"> <li>• Operating: 0 to 40 °C (32 to 104 °F)</li> </ul>	<ul style="list-style-type: none"> <li>• Storage: -20 to 65 °C (-4 to 149 °F)</li> </ul>
Humidity (main unit)	<ul style="list-style-type: none"> <li>• Operating: 10% to 90% non-condensing</li> </ul>	<ul style="list-style-type: none"> <li>• Storage: 5% to 95% non-condensing</li> </ul>
Certifications	<ul style="list-style-type: none"> <li>• FCC</li> <li>• IC</li> </ul>	<ul style="list-style-type: none"> <li>• CE</li> </ul>

Warranty	
Warranty	• 1-Year Limited Warranty <sup>5</sup>
Order Information	
Part Number	Description
DCH-S161-US	Wi-Fi Water Sensor

<sup>1</sup> This product is intended solely to help reduce damage caused by a water leak. D-Link disclaims all liability for any water damage that occurs as result of the failure of this product to properly function.

<sup>2</sup> 1.5 year battery life based on standby time with no detections.

<sup>3</sup> Please visit [mydlink.dlink.com](http://mydlink.dlink.com) for more information on mydlink products that support Smart Home functionality

<sup>4</sup> Please refer to the mobile app's store page to check whether your device is compatible.

<sup>5</sup> 1-Year Limited Warranty available in USA only. Warranty void when not purchased from Authorized US D-Link reseller. Please visit [us.dlink.com](http://us.dlink.com) for list of authorized US resellers.

Updated 2019/1/18

### For more information

**U.S.A.** | 17595 Mt. Herrmann Street | Fountain Valley, CA 92708 | 800.326.1688 | [dlink.com](http://dlink.com)

©2018 D-Link Corporation/D-Link Systems, Inc. All rights reserved. D-Link and the D-Link logo are registered trademarks of D-Link Corporation or its subsidiaries in the United States and/or other countries. Other trademarks or registered trademarks are the property of their respective owners. All references to speed are for comparison purposes only. Product specifications, size and shape are subject to change without notice, and actual product appearance may differ from that depicted herein.

Visit [us.dlink.com](http://us.dlink.com) for more details.